



Easy to operate **2**

Easier to start **1**

Easy to transport **3**

**4** Compact storage

Combine one of seven MultiTools and you're ready to go.

## Technology

- 1 Engine technology with paper air filter**  
To make the start-up sequence easier, the carburettor is equipped with a manual fuel pump. The accelerator pump ensures dynamic revving. The paper air filter reliably protects the engine from dust and dirt.
- 2 Multi-function handle**  
All the engine control functions are at your fingertips. This makes it easy and reliable to use.

## Comfort

- 3 Transport handle**  
The STIHL MultiSystem can be comfortably loaded into and out of cars thanks to the transport handle.
- 4 Folding frame**  
The STIHL MultiSystem can be quickly and easily folded away even with a tool attached, allowing it to be conveniently transported and stored.

**i** Please note that not all products are equipped with the features listed here. Only the most important features are described on this page. For further explanations and information, see page 240 onwards or online at [www.stihl.com.au](http://www.stihl.com.au).



## MM 55 MultiEngine

- For a variety of tasks: for lawn care, soil cultivation and surface cleaning
- Powerful MultiEngine
- Can be combined with a variety of MultiTools
- Folding frame for easy transportation

### MM 55



**27.2 cm<sup>3</sup>, 0.75 kW/1.0 hp, 7.9 kg<sup>①</sup>.** For a very wide range of tasks in lawn maintenance, soil cultivation and surface cleaning. Powerful drive for the STIHL MultiTools. Multi-function handle, transport handle, paper air filter, folding frame.

**Order No. 4601 200 0025**

5

MultiEngine							
Order number	Displacement (cm <sup>3</sup> )	Power output (kW/hp)	Weight (kg) <sup>①</sup>	Sound pressure level <sup>②</sup> (dB(A))	Sound power level <sup>②</sup> (dB(A))	Vibration level left/right <sup>②</sup> (m/s <sup>2</sup> )	
<b>MM 55</b>	<b>4601 200 0025</b>	27.2	<b>0.75 / 1.0</b>	7.9	92	102	2.4 / 3.6

② K factor according to Dir. 2006/42/EC = 2.5 dB(A)

② K factor according to Dir. 2006/42/EC = 2 m/s<sup>2</sup>

For suitable fuels and lubricants, see page 188 onwards.



① Weight excluding fuel and tool

For retail pricing visit [www.stihl.com.au](http://www.stihl.com.au)



5

## MultiTools and accessories

-  Seven practical MultiTools for the most varied jobs
-  Swap tools in no time



### BF-MM pick tine



Breaks up heavy, loamy soil. Ideal for recultivating and loosening the soil, working width 22 cm, weight 2.0 kg.

**Order No. 4601 740 4605**



### FC-MM lawn edge trimmer<sup>①</sup>



Perfectly cuts edges, deeply penetrating as far as the roots. Weight: 0.8 kg.

**Order No. 4601 740 4603**



### BK-MM bolo tine



Ideal for precision work. Spreads fine, sandy soil and crumbles large sods of earth, working width 22 cm, weight 2.0 kg.

**Order No. 4601 740 4606**



### RL-MM aerator<sup>①</sup>



Improves root growth. Perforates the lawn surface to ensure optimal supply of nutrients and ventilation, working width 20 cm, weight 2.0 kg.

**Order No. 4601 740 4600**



**MF-MM  
dethatcher<sup>①</sup>**

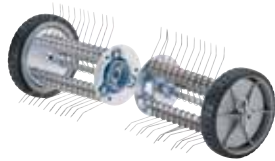

Removes moss and matted growth from the lawn surface, includes guard extension and apron, working width 50 cm. Weight: 8.3 kg.

**Order No. 4601 740 4601**



**KB-MM  
bristle brush<sup>②</sup>**



Removes dirt from paved areas or uneven natural stone surfaces, including guard extension, working width 60 cm. Weight: 4.2 kg.

**Order No. 4601 740 4602**

**Cultivator blade**



Varies the working depth and speed when cultivating soil by slightly lifting and lowering the tool into and out of the soil.

**Order No. 4601 740 4800**

**Weight kit**

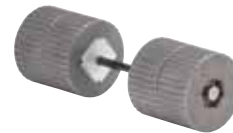

For BF-MM and BK-MM. An ideal aid when cultivating and crumbling. Increases the pressure on the tool for improved depth penetration into the ground.

**Order No. 4601 730 4500**



**KW-MM  
power sweep<sup>②</sup>**



Ideal for sweeping footpaths and roads. Removes dirt, sand, small stones and leaves. Excluding guard extension, working width 60 cm, weight 3.7 kg.

**Order No. 4601 740 4604**

**Wheel kit**



For MF-MM<sup>①</sup>, KW-MM<sup>②</sup> and KB-MM<sup>②</sup>. Allows the tool to be lifted slightly, thus reducing the resistance due to friction when dethatching, brushing and sweeping. Better manoeuvrability.

**Order No. 4601 007 1008**

② Wheel kit required